



QFB Series Bandpass Filters



SPECIFICATIONS

PERFORMANCE PARAMETER	TYPICAL CHARACTERISTICS
Range of Passband Bandwidth	2% to 20% of center frequency; standard versions 2%, 5%, 10%
Passband Attenuation (typ)	Less than 1 dB (Bandwidth & rejection dependent)
Rejection (typ)	20-40 dB at center frequency \pm bandwidth
Ripple in Passband	0.1 dB to 0.5 dB depending on percent bandwidth and rejection requirements

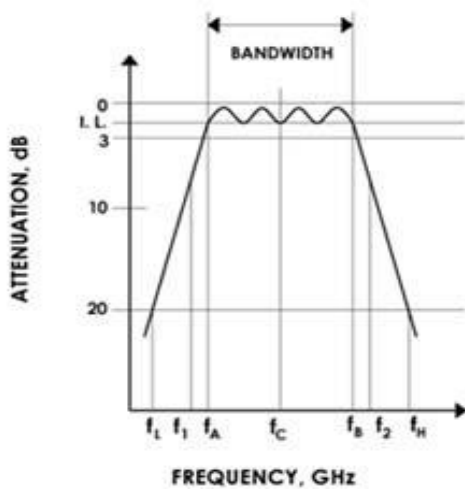

f_A, f_B : Band edges
 f_L, f_H : 20 dB rejection points



QFB Series Bandpass Filters



MECHANICAL SPECIFICATIONS/OUTLINE DRAWINGS

FREQUENCY BAND	WAVEGUIDE SIZE	FLANGE PATTERN	OUTLINE DIMENSIONS, inches/mm		
			A	B	C ¹
K	WR-42	UG-595/U	0.88/22.4	0.88/22.4	2.00/51.0
Ka	WR-28	UG-599/U	0.75/19.1	0.75/19.1	2.00/51.0
Q	WR-22	UG-383/U	1.12/28.4	1.12/28.4	1.50/38.1
U	WR-19	UG-383/U	1.12/28.4	1.12/28.4	1.50/38.1
V	WR-15	UG-385/U	0.75/19.1	0.75/19.1	1.50/38.1
E	WR-12	UG-387/U	0.75/19.1	0.75/19.1	1.00/25.4
W	WR-10	UG-387/U-M	0.75/19.1	0.75/19.1	1.00/25.4
F	WR-8	UG-387/U-M	0.75/19.1	0.75/19.1	1.00/25.4
D	WR-6	UG-387/U-M	0.75/19.1	0.75/19.1	1.00/25.4
G	WR-5	UG-387/U-M	0.75/19.1	0.75/19.1	1.00/25.4

1 Standard versions only. Length may vary depending on specifications. Contact QuinStar for exact length.

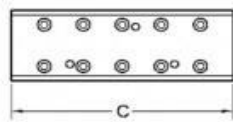
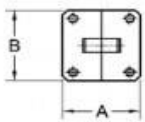

WR-42 and WR-28

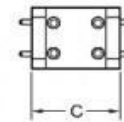
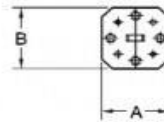

WR-22 through WR-5