



# Circular-to-Rectangular Waveguide Transitions

QWC

## Characteristics

- ◆ 26.5 to 220 GHz
- ◆ Low VSWR
- ◆ Minimum Insertion Loss

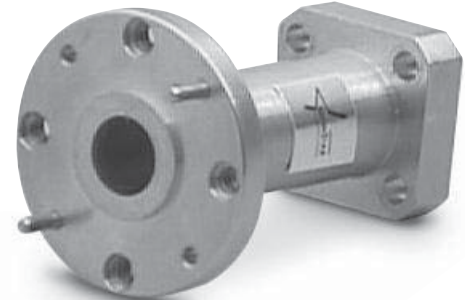

## Product Description

QuinStar Technology's **QWC** series **circular-to-rectangular waveguide transitions** cover the frequency range of 18 to 220 GHz in ten waveguide bands. The waveguide transitions are used to connect standard rectangular waveguide to circular waveguide with a minimum of loss

and reflections. They are available with a variety of flange types to join two components of the same waveguide size which differ in both waveguide aperture size and flange types. The transitions have a wide bandwidth and low VSWR.

## Specifications

FREQUENCY BAND	K	Ka	T	Q	U	V	E	W	F	D	G
Frequency Range (GHz)	18-26.5	26.5-40	18-40	33-50	40-60	50-75	60-90	75-110	90-140	110-170	140-220
Insertion Loss (dB max)	0.3	0.3	0.3	0.4	0.5	0.6	0.7	0.8	0.8	1.0	1.0
VSWR (max)	1.10	1.10	1.10	1.10	1.15	1.15	1.15	1.15	1.15	1.15	1.15
Length, inches/mm (typ)	2.0/50.8	1.50/38.1	1.50/38.1	1.50/38.1	1.50/38.1	1.10/27.9	1.10/27.9	1.10/27.9	1.10/27.9	1.10/27.9	1.10/27.9
Flange Pattern	UG-595/U	UG-599/U	WRD-180	UG-383/U	UG-383/U	UG-385/U	UG-387/U	UG-387/U-M	UG-387/U-M	UG-387/U-M	UG-387/U-M

Other waveguide sizes are available.

## Ordering Information

